VISSONIC

Professional Audio Video Manufacturer

Full Digital Wired Conference Units

Product Datasheet



VISSONIC ELECTRONICS LTD.

Think Solution

VISSONIC Full Digital Networked DSP Conference System

Application diagram

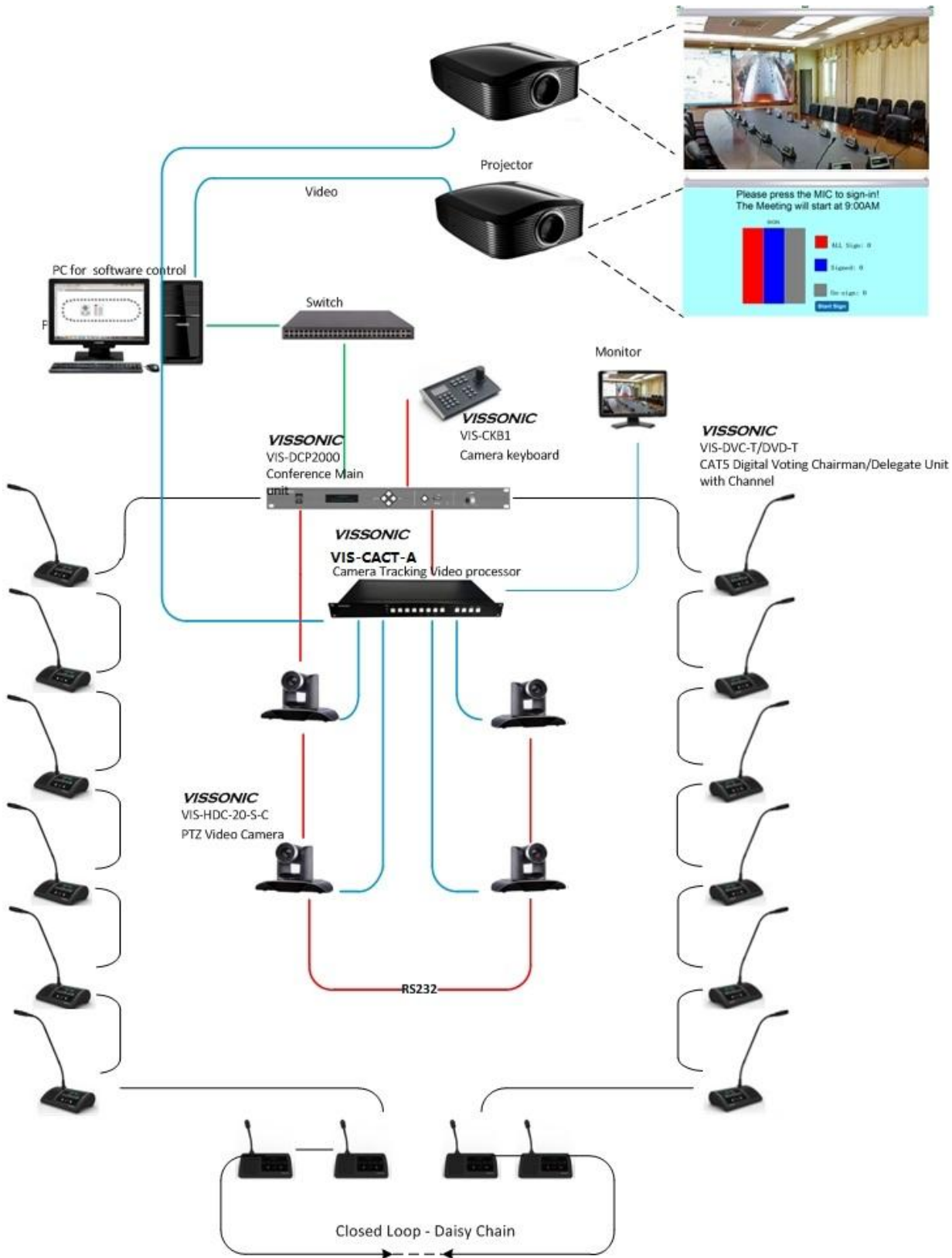

VIS-DCP2000-D

Full Digital Networked DSP Conference Processor for wired units



Features

- The unique AUDIO-LINK digital ring network technology achieve full-digital signal transmission and processing
- One CAT5e cable to transmit up 64 channels audio and other signals.
- All microphone units support audio, ID independent output. Working with voice recognition system to achieve voice role separation.
- High-fidelity sound quality by lossless audio transmission technology, 48K audio sampling rate and 20Hz ~ 20KHz frequency response
- A single conference controller can realize the independent control and merging of 4 conference rooms, can handle the cascade of multiple conference controllers to realize the merging and separation of larger conference rooms (Optional).
- "Hand-in-Hand-Loop-Network" connection makes the system always working perfectly no matter changing discussion unit or having any malfunctioned units
- The sensitivity of the unit microphone and 8 segment equalizer EQ adjusted independently.
- Conference controller can output 16 segment equalized EQ to achieve sound field adjustment; pressure limit, which can recognize the noise gate passed by human voice. AGC automatic volume gain control; AFC automatic feedback suppression and auto-mix technology.
- Sound output by separated zones function, each zone is automatically adjusted according to the volume of the position of the microphone, achieve longer distances pickup without whistle.
- Echo cancellation, remote two-way real-time call with another conference controller or another third-party video conferencing terminal.
- USB recording, controller monitor, advanced noise cancellation technology to realize clearer recording.
- System date, time management, and support count-down speech.
- Optional DANTE output module with other DANTE equipment used.
- Can drive 2x120W POE speaker, through extension main unit, support up to 16 POE speakers.

Functions

- Compliance with IEC 60914, GBT 15381-94
- Connect with VIS-EXM full-digital extension main unit, it can expand to 5200 discussion units
- "Hand-in-Hand-Loop-Network" connection and the system assigned to each unit independently ID to avoid ID conflict.
- Only wired discussion units can connect to the controller, fast and easily to adding delegate of meetings.

CLEACON Series VIS-DVCIC-T/VIS-DVDIC-T

CAT5 Wired Digital **Discussion+** Voting IC Card Chairman/Delegate Unit with Channel Selector



Features

- Stylish, low profile design with touchable interface
- Standard CAT5e and RJ45 connectors are used in CLEACON series to provide more convenient on project and maintenance.
- The connection cable of units are either hiding underneath or from the rear of the unit, makes it convenient for different request of installation
- Five keys voting function
- Interpretation function with 64 channels selector which can display the language and channel number (Insert the earphone and the channel selector is active)
- OLED screen, providing excellent brightness, contrast, wide viewing angle but low power consumption
- Internal high-fidelity loudspeaker
- Head-set interface in both sides with volume adjust
- Line-in interface which allows microphone or other line-in device like cell phone, laptop to pass audio through to perform teleconference
- The unique AUDIO-LINK digital ring network technology achieves full-digital signal transmission and processing, completely avoiding the RF interference from cell phone or similar devices.
- "Hand-in-Hand-Loop-Network" connection makes the system always working perfectly and more reliable.
- The unit showing time/date on the screen. Timer on display to set certain time for each delegate to speak will remind user or close the MIC automatically.
- All units can be configured as Chairman or Delegate unit through software settings based on model VIS-DVC-T.

Functions

- Compliance with IEC 60914, GBT 15381-94
- The unique AUDIO-LINK digital ring network technology achieves full-digital signal transmission and processing, completely avoiding the RF interference from cell phone or similar devices.
- Single CAT5e cable transmits 64 channels of audio and various information

VIS-M600/VIS-M485/VIS-M410/VIS-M330/VIS-M220

Pluggable Gooseneck Microphone



Features

- Precise directional microphone head with Mini design
- Two color LED ring indicator
- anti-wind microphone foam cover
- Strong audio collection ability to work with different length of microphone

Functions

- Two-color LED indicator on microphone, red for speaking, green means need acceptance from chairman to speak
- Screw lock socket to connect removable microphone

Technical Parameters

Item	VIS-M600	VIS-M485	VIS-M410	VIS-M330	VIS-M220
Directivity	Cardioid				
Sensitivity	-46dBV/Pa				
Frequency response	30Hz~20KHz				
Equivalent noise	20dBA (SPL)				
Signal-To-Noise Ratio Ref	≥96dB				
Microphone Type	Condenser				
Maximum SPL (1 kHz at 1% THD, 1 kΩ load)	125dB (THD<3%)				
Conference unit connection	Mini 6 pin.				

VIS-ICCARD

Contactless IC card



Features

- Proven, Reliable Technology - Offers extremely consistent read range
- Fast Processing and Data Communication
- True Credit Card Thickness

Technical Parameters

Dimensions: 2.125 x 3.375x .03" (5.4 x 8.57 x 0.076 cm)

Weight: 6g

Typical Maximum Read Range: Up to 4" (10cm)

Operating Frequency: 13.56MHz

RF Interface: ISO/IEC 14443A/MIFARE, Parts 1-3

Transaction Time: < 100ms

Baud Rate: 106 kbps

Data Retention: 10 years min.

Overview

MRX7-D offers outstanding processing and flexibility for a broad range of audio installations.



Rear Panel

Features

- Inputs; 8 mono (mic/line), 2 stereo (line), 16 digital (via YDIF^{*1})
- Outputs; 8 mono (line), 16 digital (via YDIF^{*1})
- EXi8/EXo8 expanders available for increasing analog I/O via YDIF
- On-board 64 Channel I/O Dante Interface for larger networked systems
- Mini YGDAI card slot offers further expandability and compatibility with other audio formats
- SD Card slot for playback of MP3/WAV audio files stored on SD Card
- Built-in processing solutions include - Dugan Automixer, Acoustic Echo Canceller^{*2} and Speech Privacy System
- Remote control of levels and presets from the DCP series of wall mount controllers
- Wireless DCP for iOS and Android devices available for free
- 16In/8Out GPI ports for additional external control
- Network port offers connectivity with touch screen control systems such as AMX and Crestron
- Easy setup and parameter control with MTX-MRX Editor
- ProVisionaire Touch for iPad offers custom control panel design and operation, free from the App Store

*1 YDIF: the newly developed digital transmission format; a unique propriety Yamaha technology that delivers 16ch audio and word clock transmission via standard CAT5 Ether cable.

*2 Available in version 2.1 and later.

Technical Specifications

General Specifications

Model		VXL1(B/W)-24	VXL1(B/W)-16	VXL1(B/W)-8
Speaker type		Full-range, Bass reflex		
Component		1.5" (3.75 cm) Cone x 24	1.5" (3.75 cm) Cone x 16	1.5" (3.75 cm) Cone x 8
Coverage (-6 dB)		Horizontal: 170° Vertical: NORMAL: 15° (+7.5° - -7.5°), WIDE: 20° (+7.5° - -12.5°)	Horizontal: 170° Vertical: NORMAL: 25° (+12.5° - -12.5°), WIDE: 30° (+12.5° - -17.5°)	Horizontal: 170° Vertical: 40° (+20° - -20°)
Effective coverage (-10 dB)		Horizontal: 180° Vertical: NORMAL: 25° (+12.5° - -12.5°), WIDE: 35° (+12.5° - -22.5°)	Horizontal: 180° Vertical: NORMAL: 30° (+15° - -15°), WIDE: 45° (+15° - -30°)	Horizontal: 180° Vertical: 65° (+32.5° - -32.5°)
Nominal impedance		8Ω	12Ω	16Ω
Power rating	NOISE	110 W	80 W	40 W
	PGM	220 W	160 W	80 W
	MAX	440 W	320 W	160 W
Sensitivity (1 m/1 W)*1, *2		91 dB SPL (91 dB SPL: with port cover)	91 dB SPL (90 dB SPL: with port cover)	89 dB SPL (88 dB SPL: with port cover)
Maximum SPL*3		117 dB SPL (1 m)	116 dB SPL (1 m)	111 dB SPL (1 m)
Frequency range (-10 dB)*1		77 Hz - 20 kHz	81 Hz - 20 kHz	70 Hz - 20 kHz
	(With port cover)	98 Hz - 20 kHz	108 Hz - 20 kHz	110 Hz - 20 kHz
Connector		Euroblock (2 pin) x 2 (input: +/-) Max. wire size AWG12 (3.5 sq)		
Vertical coverage selector		NORMAL/WIDE		-
Overload protection		Full-range power limiting to protect network and transducers		
Magnetically shielded		No		
Dust and water resistant		IP34 (with port cover: IP35)		IP33 (with port cover: IP35)
Enclosure	Cabinet material	VXL1B-24/16/8: Aluminum extrusion cabinet, black VXL1W-24/16/8: Aluminum extrusion cabinet, white		
	Top/Bottom board material	ABS(UL94-5VB)		
Metal grille		Perforated aluminum (t=1.0 mm) Aperture ratio: 55%		
Finish		VXL1B-24/16/8: Black painting (approximate value: Munsell N3.0) VXL1W-24/16/8: White painting (approximate value: Munsell N9.0)		
Dimensions (W x H x D)	Speaker only	54 x 1212 x 104 mm	54 x 846 x 104 mm	54 x 480 x 104 mm
	With included bracket	54 x 1212 x 111.5 mm	54 x 846 x 111.5 mm	54 x 480 x 111.5 mm
Net weight	Speaker only	5.5 kg	3.9 kg	2.1 kg
Packaging		Packaged in 1 pc		

*1 : Half-space (2 π)

*2 : Measured at 2 m; value converted to 1 m is shown (frequency range: 100 Hz - 10 kHz)

*3 : Calculated based on power rating and sensitivity, exclusive of power compression.

Dimensions

VXL1(B/W)-24

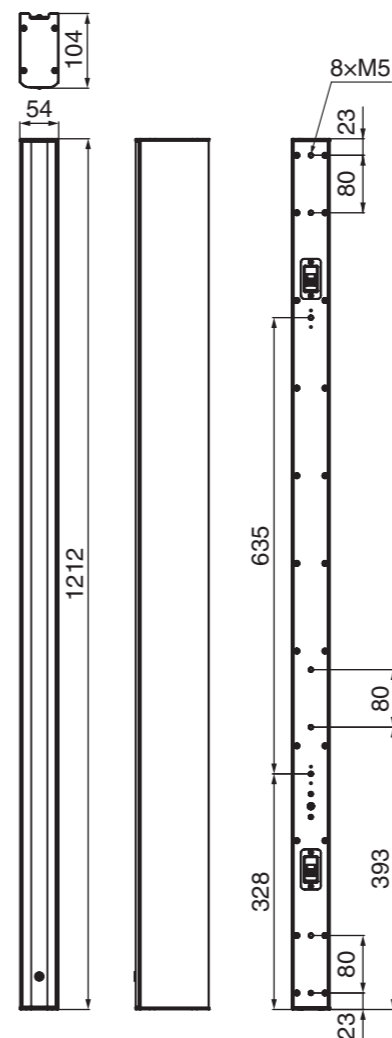

VXL1(B/W)-16

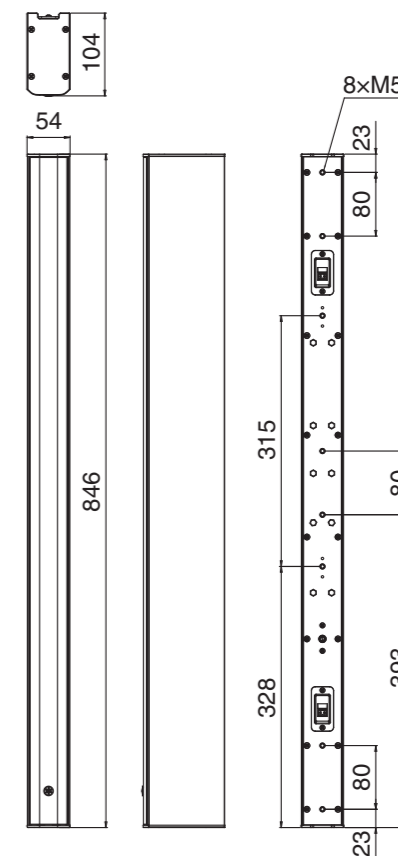

Mount Bracket

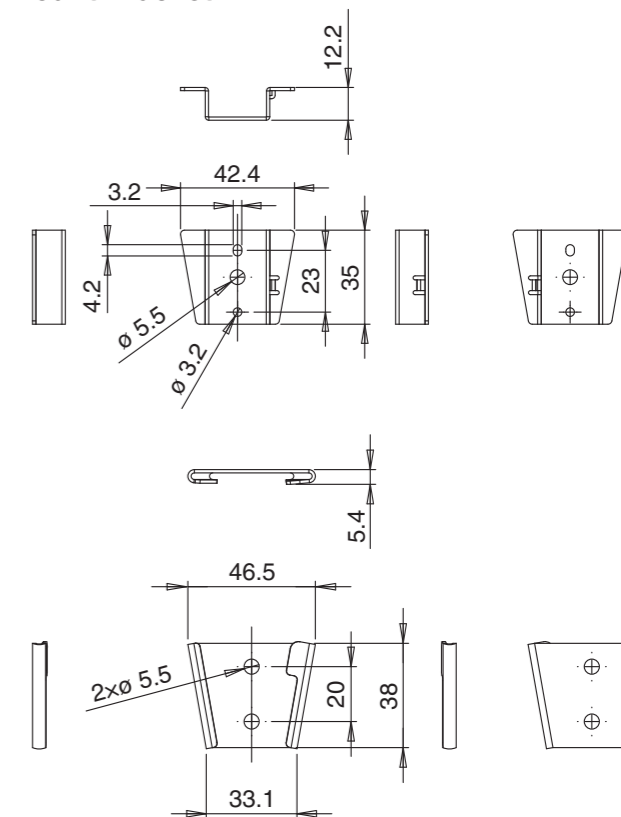

Unit: mm

VXL1(B/W)-8

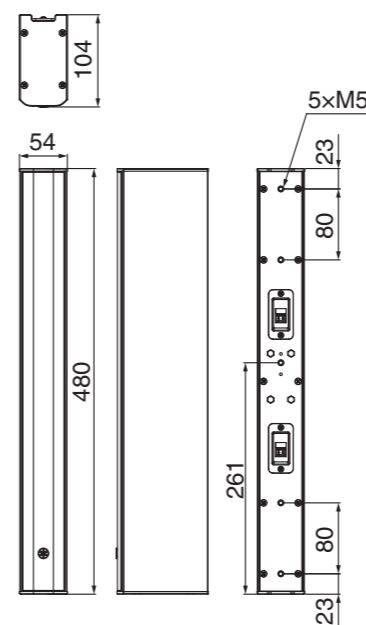

* The contents of this manual apply to the latest specifications as of the publishing date. To obtain the latest manual, access the Yamaha website then download the manual file.



PEAKER ACCESSORY

ST-L1B ST-L1W
 WMB-L1B WMB-L1W
 VCB-L1B
 VCSB-L1B VCSB-L1W
 HCB-L1B

EN

Technical Specifications

General Specifications

Model	ST-L1(B/W)	
Supported speaker	VXL1(B/W)-24/16/8	
Transformer taps	100 V	60 W, 30 W, 15 W
	70 V	60 W, 30 W, 15 W, 7.5 W
Speaker selector	VXL1(B/W)-24	
	VXL1(B/W)-16	
	VXL1(B/W)-8	
Dust and water resistant	IP35	
Dimensions (W × H × D)	54 × 247 × 103 mm	
Net weight	1.9 kg	

Model	WMB-L1(B/W)	VCB-L1B	VCSB-L1(B/W)	HCB-L1B
Material	Aluminum	Steel	Steel	Steel
Net weight	0.3 kg	0.23 kg	0.4 kg	(L) 0.19 kg (S) 0.06 kg

Dimensions

ST-L1(B/W)

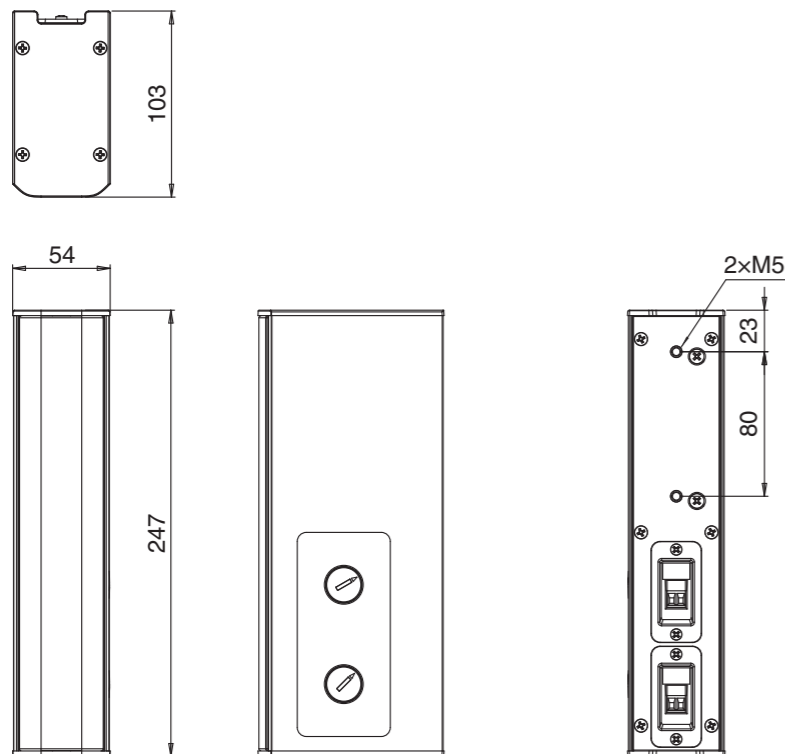

WMB-L1(B/W)

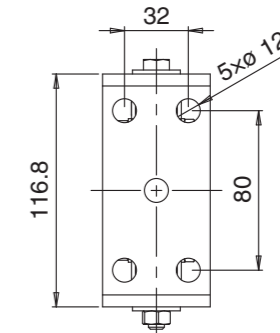
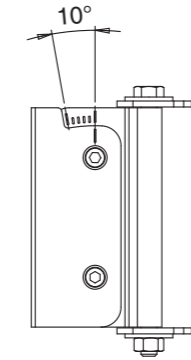
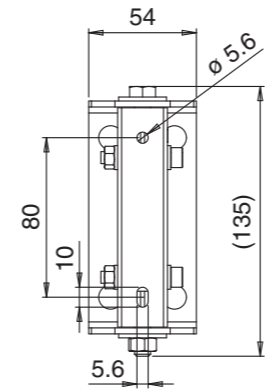
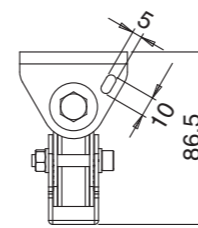

VCB-L1B

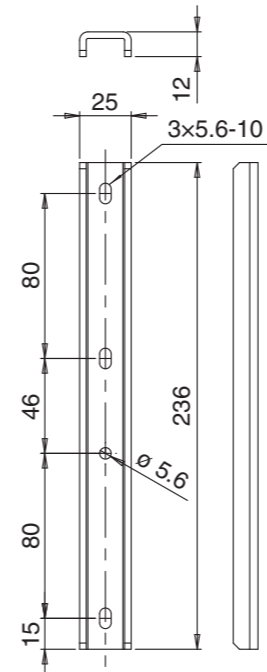

VCSB-L1(B/W)

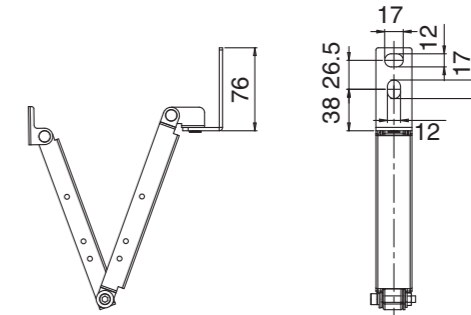
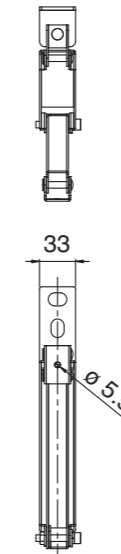

HCB-L1B

Coupling bracket (L)

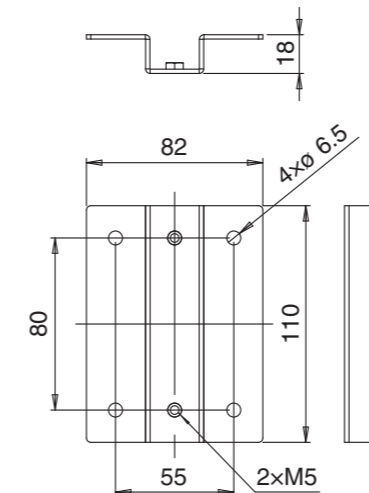

Coupling bracket (S)

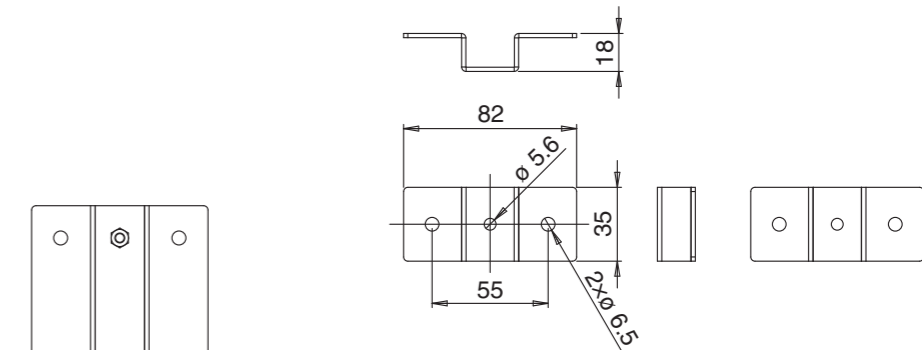

Unit: mm



Overview

Wall mount control panel for MTX/MRX series with LCD screen. Easy connection by Ethernet cable.



Rear Panel

Features

- 6 buttons can be assigned to any functions *MTX/MRX series functions (components) are specified via the MTX-MRX Editor
- Multi-language displays supported
- Four user levels for access management
- Up to 16 units can be connected per system
- PoE powered
- Back can adapter supplied



Overview

Multi-channel power amplifiers with features designed specifically to benefit installation sound systems.



Features

- Four-channel power amp that can operate in both high-impedance (70V/100V line) or low-impedance (4Ω/8Ω) modes simultaneously.
- 70V or 100V mode can be assigned to every pair of channels without affecting the number of available output channels.
- The newly developed Double Power Mode function effectively doubles the output power of selected channels.
- Equipped with YDIF* digital audio format for simple and fast system configuration.
- Easy setting such as the mute on/off or attenuator changes with MTX Editor when used in system with MTX Series.
- An innovative, new, patent pending circuit improves the already highly efficient Class D circuit topology, bringing the efficiency level of the amplifier's output stage up to over 90%.
- Feature a Power Factor Correction equipped switching power supply, ensuring harmonic control and decreasing the amount of current draw while maintaining the same output power.
- Powerful, intelligent protection features for more reliable operation.

* YDIF: the newly developed digital transmission format; a unique propriety Yamaha technology that delivers 16ch audio and word clock transmission via standard CAT5 Ether cable.



Overview

Multi-channel power amplifiers with features designed specifically to benefit installation sound systems.



Features

- Eight-channel power amp that can operate in both high-impedance (70V/100V line) or low-impedance (4Ω/8Ω) modes simultaneously.
- 70V or 100V mode can be assigned to every pair of channels without affecting the number of available output channels.
- The newly developed Double Power Mode function effectively doubles the output power of selected channels.
- Equipped with YDIF* digital audio format for simple and fast system configuration.
- Easy setting such as the mute on/off or attenuator changes with MTX Editor when used in system with MTX Series.
- An innovative, new, patent pending circuit improves the already highly efficient Class D circuit topology, bringing the efficiency level of the amplifier's output stage up to over 90%.
- Feature a Power Factor Correction equipped switching power supply, ensuring harmonic control and decreasing the amount of current draw while maintaining the same output power.
- Powerful, intelligent protection features for more reliable operation.

* YDIF: the newly developed digital transmission format; a unique propriety Yamaha technology that delivers 16ch audio and word clock transmission via standard CAT5 Ether cable.

Elevatori per Luci

24630

Elevatore per barre portafari
2 sezioni regolabili



Colore: nero
Vite di testa: M10
Portata: 20 kg
Altezza: 195-292 cm
Peso: 6,4 kg

246/1

Elevatore con verricello
a cremagliera di sicurezza
per barre portafari
Base in acciaio 2 sezioni
Colore: nero
Portata: 30 kg
Filetto di testa: M10
Altezza: 184-305 cm
Peso: 7,5 kg



213/3

Tubo di estensione
Acciaio con attacco a vite
per elevatori
Modello 213-246/1
Colore: nero
Altezza: 1000 mm
Filetto di base: M10
Vite di testa: M10
Peso: 1,9 kg



213/9

Barra portafari
Adatta per 4 fari PAR56/64
per elevatore 246/1



Dimensioni: 1250x40x20 mm
Peso: 2 kg

24500

Supporto scorrevole
per barra portafari supplementare
su elevatore 246/1
Colore: nero
Per tubo: 35 mm



21393

Volantino Maschio e Femmina
Per fissaggio fari su barra 213/9
Colore: nero
Diametro: 50 mm
Lunghezza vite: 45 mm
Filetto: M8
Kit: 4 pezzi



TOP-4

Adattatore universale in acciaio
per barra portafari su elevatori
o per diffusori acustici
Passo: diam. 35 mm
Flangia: 175x110 mm



24528

Adattatore
per barra portafari 213/9
su elevatori:
21452s -24640 - 246/1
Passo: diam. 35 mm
Vite di testa: M10



24640

Elevatore per barre portafari
3 sezioni regolabili
Colore: nero
Vite di testa: M10
Portata: 20 kg
Altezza: 159-400 cm
Peso: 12,5 kg



24611

Borsa per 2 elevatori
Idrorepellente
Adatta per i vari modelli di Elevatori Luci tipo 24630-24640-246/1
Dimensioni: 2250x320x170 mm



LIGHTWEIGHT STANDS



195S Baby Kit Stand W/ Square Tubular Legs

3 risers, 4 sections.
Dia.: 35mm, 30mm, 25mm, 20mm
Leg size.: 22mm x 22mm
Aluminum material
With 1 leveling leg
Welding stand top

						
124cm 48.9"	400cm 157.5"	108cm 42.5"	4.5kg 9.9lbs	112cm 44.1"	10kg 22lbs	A

MASTER C STAND w/ Sliding Leg Kits



CS-40MK 40" C Stand Kits Silver

including : CS-40M/B, KCP-200/B and KCP-241/B

						
132cm 51.9"	323cm 127.1"	134cm 52.8"	6.4kg 14.08lbs	100cm 39.4"	10kg 22lbs	A

Master Series C Stand Kits with Sliding Leg C-Stand
including one grip arm and 2.5" grip head
2 riser, 3 sections
Dia. 35mm, 30mm, 25mm
Chrome plated steel for silver

ACT-848A
*Ricevitore Digitale Wideband
4 canali*



Power Switch
Headphone Monitor Connector
Headphone Monitor Volume Control
Channel Indicator

VFD Screen

Rotary Knob
ACT Sync Button
CH 1-4 Selector

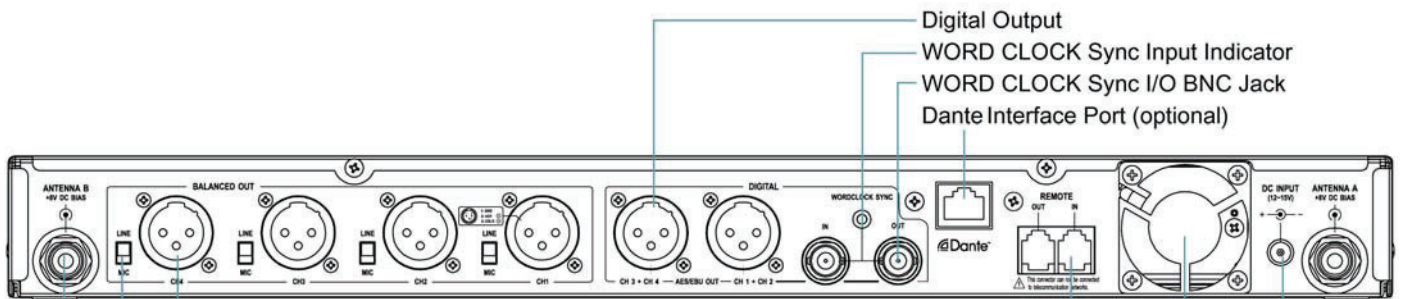

Digital Output
WORD CLOCK Sync Input Indicator
WORD CLOCK Sync I/O BNC Jack
Dante Interface Port (optional)

Balanced XLR Audio Output
Mic / Line Switch
Antenna Connector

DC Input Jack
Heat Sink
Network Interface Connectors

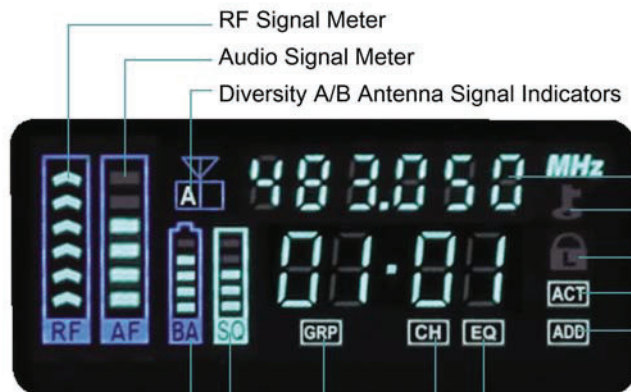

RF Signal Meter
Audio Signal Meter
Diversity A/B Antenna Signal Indicators

Working Frequency
Encryption Status Icon
Parameter Lock Icon
ACT Indicator
Address Code

Group
Squelch Meter
Transmitter Battery Meter
Equalizer
Channel

opzione Dante

*I modelli ACT-828A e ACT-848A possono essere
forniti anche con la scheda Dante*

ACT-Dante
Scheda Dante



ACT-80H

Trasmettitore Impugnatura

ACT-80HC

Trasmettitore Impugnatura
con batteria al Litio ricaricabile



- Custodia dal design innovativo unisce estetica e ergonomia.
- La griglia superiore metallica a più livelli per capsule a condensatore e per capsule dinamiche è progettata per proteggere la capsula contro gli urti, il rumore di rotolamento e pop. Può essere staccata facilmente per pulizia ed igiene.
- Il disegno di sospensione delle capsule brevettato elimina virtualmente le vibrazioni e rumori da manipolazione.
- La capsula True-Condenser offre alta fedeltà sonora, ampia gamma dinamica, risposta ai transienti veloce, buona reiezione al feedback, suono preciso e trasparente e massimo SPL.

- Capsula intercambiabile a condensatore o dinamica per il cambio facile e veloce.
- Il display LCD retroilluminato indica la banda di frequenza, gruppo canale, stato della batteria, lo stato della crittografia, RF e i livelli audio.
- Interruttore di accensione, tasti mute e di impostazione di guadagno programmabile, limitatore, taglio basso e potenza di uscita RF.
- Tre impostazioni mute selezionabili: Auto, Manuale e Disabilitato. "Auto" mute attiva automaticamente quando rileva trasmettitore a mano verso il suolo.
- Tre impostazioni selezionabili di guadagno: 0 dB (stessi come la sensibilità del microfono), +3 dB, +6 dB.
- Un canale senza interferenze può essere sincronizzata automaticamente e velocemente senza errori con la funzione ACT™ sync brevettata MIPRO.
- Due impostazioni selezionabili di potenza d'uscita del trasmettitore: HI (alta potenza) e LOW (basso consumo).



- Mute Button
- Audio Input Connector
- LCD Display Panel
- Remote Mute Connector
- ACT IR Port
- SET Button
- MODE Button
- Power Button

- Trasmettitore Beltpack ACT-80T extra sottile con custodia resistente in lega di magnesio.
- Antenna staccabile, mini interruttore On/Off e connettore mini XLR a 4 poli.
- Display LCD retroilluminato visualizza varie informazioni di funzionamento.
- Coperchio della batteria dal design innovativo permette un facile accesso per usare i pulsanti di controllo e impedisce il funzionamento accidentale.
- Tasto Mute con la presa di controllo remoto per una facile attivazione della funzione mute.
- Circuito PLL Stabile. Sincronizza la frequenza del ricevitore automaticamente con la funzione ACT™ brevettata MIPRO.
- Selezione della polarizzazione per l'ingresso audio per abbinare diverse capsule con diverse polarizzazioni.
- Sei impostazioni di guadagno selezionabili.
- Ingresso mini-XLR con connettore a vite di bloccaggio sicuro per lavalier, headset e chitarra.
- 2 batterie AA forniscono fino a 12 ore di funzionamento.
- Clip da cintura che permette di indossare il trasmettitore in varie posizioni.

ACT-80T

Trasmettitore Beltpack

ACT-80TC

Trasmettitore Beltpack
con batteria al Litio ricaricabile

TA-80

Trasmettitore
Universale



Il TA-80 è un trasmettitore Digitale in miniatura con presa microfonica XLR. Progettato per microfoni di misura, microfoni a condensatore, microfoni dinamici, microfoni di registrazione e microfoni per strumenti musicali. Compatibile con i ricevitori serie 8Pro Digital.

- TA-80 ha una risposta in frequenza piatta e estesa, un livello di rumorosità estremamente basso, una risposta transitoria veloce, una forte anti-interferenza e un'elevato S/N. Queste caratteristiche superiori sono sufficienti per risolvere qualsiasi problema.
- È il miglior sistema per riprodurre il suono naturale di qualsiasi microfono a filo di alta qualità.
- TA-80 dispone di 8 livelli di guadagno e di alimentazione Phantom commutabile da 12/48V, fino a 10 mA
- Una batteria al litio ad alta capacità incorporata consente da 5 a 8 ore di utilizzo per ogni carica.
- Il TA-80 è compatto, leggero e robusto è compatibile anche con ricevitori digitali in miniatura ACT-80/80R per una varietà di applicazioni audio professionali.

AT-70Wa Wideband Transmitting and Receiving Omni-directional Antenna



AT-70Wa is a bi-functional omni-directional antenna for professional receiving and transmitting applications. It is optimized for 470 ~ 1000 MHz, which is fully compatible with US and EU new telecom regulations. It has a 2 ~ 4 dBi gain which is ideal for any specific installation requiring full directionality. It can be easily distinguished by its new "W-Shape" appearance.

The AT-70Wa has two input connectors: "TX/RX" connector can be connected to a transmitter or receiver, however, connection to a short coaxial cable is recommended when connected to a receiver. "RX" connector (cannot be connected to a transmitter) has a built-in 0 ~ 12 dB \pm 1 dB gain adjustable booster, and thus provides extended reception range and compensates the signal loss of coaxial cable to improve reception range and signal quality.

The AT-70Wa offers users the options of transmitting or receiving based on their actual application. The power of gain controllable booster can be provided by a MIPRO AD-708 antenna divider or any MIPRO ACT Series receivers which provides bias by adding an adjustor on their antenna connectors.

Antenna Pattern

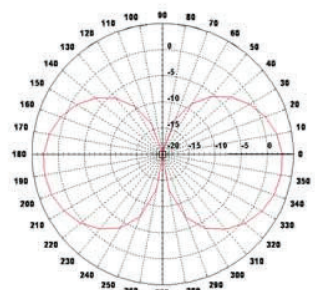

Vertical

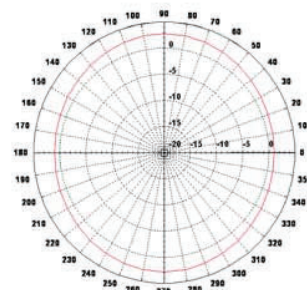

Horizontal

AT-90Wa Wideband Transmitting and Receiving Log Antenna



The AT-90Wa is a bi-functional log antenna for professional receiving and transmitting applications. Optimized for 470 ~ 1000 MHz, it is compatible with US and EU new telecom regulations. It has a 4 ~ 6 dBi gain which is ideal for any installation requiring specific directionality. The wideband ACT-90Wa can be easily distinguished from its predecessor, the AT-90, by its new "W-Shaped" design.

The AT-90Wa has two input connectors: "TX/RX" connector can be connected to a transmitter or receiver, however, connection to a short coaxial cable is recommended when connected to a receiver. "RX" connector (cannot be connected to a transmitter) has a built-in 0 ~ 12 dB \pm 1 dB gain adjustable booster and thus provides extended reception range and compensates the signal loss of coaxial cable to improve reception range and signal quality.

The power of gain controllable booster can be provided by a MIPRO AD-708 antenna divider or any MIPRO ACT Series receivers which provides bias by adding an adjustor on their antenna connectors.

Antenna Pattern

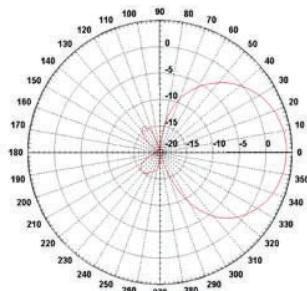

Vertical

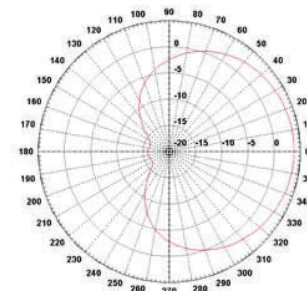

Horizontal